

TERMINATION OPTIONS

M1 STD. SOLDER LUG

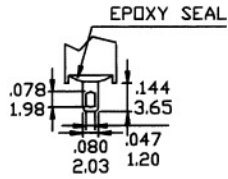

THK .030 (0.75)

M2 PC THRU-HOLE

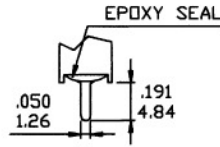

THK .030 (0.75)

M3 QUICK CONNECT

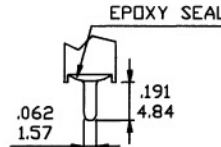

THK .030 (0.75)

M5 WIRE WRAP

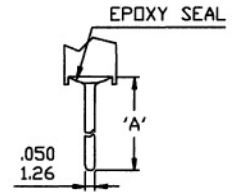

THK .030 (0.75)

OPTION CODE	DIM. 'A'
M5-1	.711(18.05)
M5-2	.924(23.48)
M5-3	.386(9.80)
M5-4	1.022(25.97)

M6



SPDT

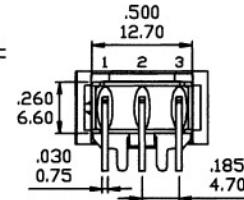
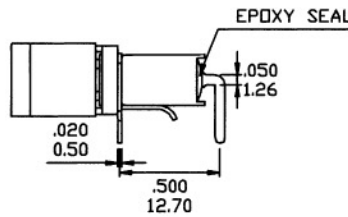
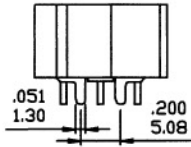

P.C. MOUNTING

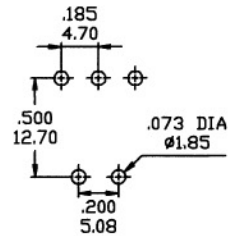

M6



DPDT

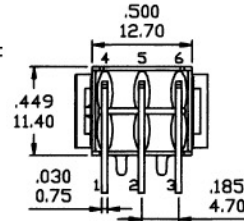
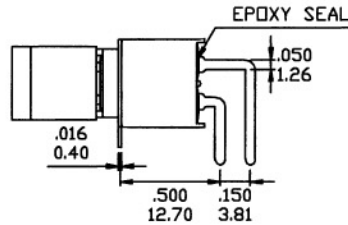
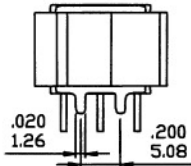

P.C. MOUNTING

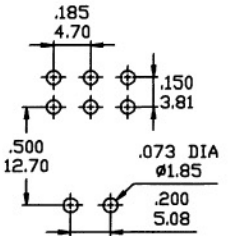

M6

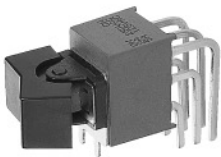

3PDT

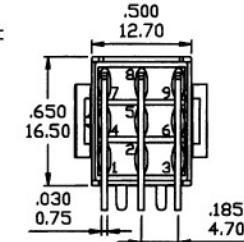
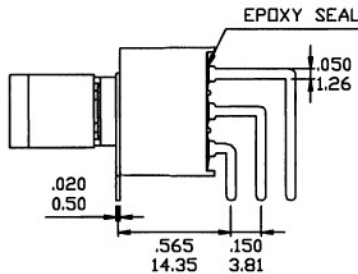
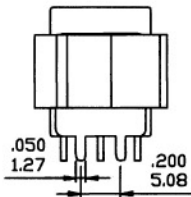

P.C. MOUNTING

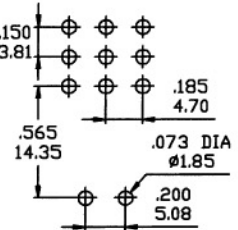

M7



SPDT

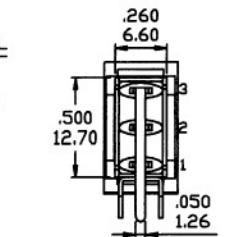
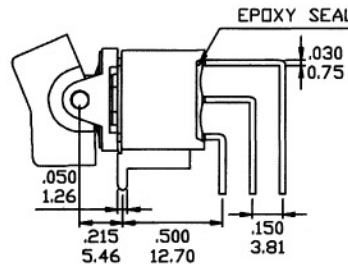
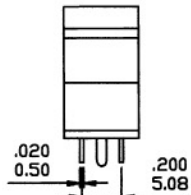

P.C. MOUNTING

